



## Alcohol and Entertainment Licensing Sub-Committee

**Tuesday 3 October 2023 at 2.00 pm**

**Boardrooms 1 & 2, 3rd floor, Brent Civic Centre**

Please note that this meeting will be held in person with members of the Sub-Committee required to attend in person.

**The press and public are also welcome to attend this meeting in person. Please note the meeting is not scheduled for live webcast**

### Membership:

#### Members

Councillors:

Ahmed (Chair)  
Collymore  
Mahmood

#### Substitute Members

Councillors:

Bajwa, Chohan, Ethapemi, Hack, Long, Lorber, Rubin

**For further information contact:** Devbai Bhanji, Governance Assistant  
Tel: 020 8937 6841; Email: [devbai.bhanji@brent.gov.uk](mailto:devbai.bhanji@brent.gov.uk)

For electronic copies of minutes, reports and agendas, and to be alerted when the minutes of this meeting have been published visit:

**[www.brent.gov.uk/committees](http://www.brent.gov.uk/committees)**

**The press and public are welcome to attend this meeting**

### **Notes for Members - Declarations of Interest:**

If a Member is aware they have a Disclosable Pecuniary Interest\* in an item of business, they must declare its existence and nature at the start of the meeting or when it becomes apparent and must leave the room without participating in discussion of the item.

If a Member is aware they have a Personal Interest\*\* in an item of business, they must declare its existence and nature at the start of the meeting or when it becomes apparent.

If the Personal Interest is also significant enough to affect your judgement of a public interest and either it affects a financial position or relates to a regulatory matter then after disclosing the interest to the meeting the Member must leave the room without participating in discussion of the item, except that they may first make representations, answer questions or give evidence relating to the matter, provided that the public are allowed to attend the meeting for those purposes.

### **\*Disclosable Pecuniary Interests:**

- (a) **Employment, etc.** - Any employment, office, trade, profession or vocation carried on for profit gain.
- (b) **Sponsorship** - Any payment or other financial benefit in respect of expenses in carrying out duties as a member, or of election; including from a trade union.
- (c) **Contracts** - Any current contract for goods, services or works, between the Councillors or their partner (or a body in which one has a beneficial interest) and the council.
- (d) **Land** - Any beneficial interest in land which is within the council's area.
- (e) **Licences**- Any licence to occupy land in the council's area for a month or longer.
- (f) **Corporate tenancies** - Any tenancy between the council and a body in which the Councillor or their partner have a beneficial interest.
- (g) **Securities** - Any beneficial interest in securities of a body which has a place of business or land in the council's area, if the total nominal value of the securities exceeds £25,000 or one hundredth of the total issued share capital of that body or of any one class of its issued share capital.

### **\*\*Personal Interests:**

The business relates to or affects:

- (a) Anybody of which you are a member or in a position of general control or management, and:
  - To which you are appointed by the council;
  - which exercises functions of a public nature;
  - which is directed is to charitable purposes;
  - whose principal purposes include the influence of public opinion or policy (including a political party or trade union).
- (b) The interests a of a person from whom you have received gifts or hospitality of at least £50 as a member in the municipal year;

or

A decision in relation to that business might reasonably be regarded as affecting the well-being or financial position of:

- You yourself;
- a member of your family or your friend or any person with whom you have a close association or any person or body who is the subject of a registrable personal interest.

# Agenda

Introductions, if appropriate.

Item	Page
<b>1 Apologies for absence and clarification of alternate members</b>	
<b>2 Declarations of Interests</b>	
Members are invited to declare at this stage of the meeting, the nature and existence of any relevant disclosable pecuniary or personal interests in the items on this agenda and to specify the item(s) to which they relate.	
<b>3 Application for New Premises Licence by Mr Kajanthan Karthigesu for the premises known as Newshare, 33 Craven Park Road, NW10 8SE, pursuant to the provisions of the Licensing Act 2003</b>	1 - 26

**Date of the next meeting: Date Not Specified**



- Please remember to **SWITCH OFF** your mobile phone during the meeting.
- The meeting room is accessible by lift and seats will be provided for members of the public.

This page is intentionally left blank

## LICENSING ACT 2003

### Application for New Premises Licence

#### 1. The Application

Name of Applicant:	Mr Kajanthan Karthigesu
Name & Address of Premises:	Newsfare, 33 Craven Park Road, NW10 8SE
Applicants Agent:	

The application is for a new premises licence:

- 1 For the sale and supply of alcohol and to remain open from 7am to 11pm Monday to Sunday.

#### 2. Background

The review of the Statement of Licensing Policy has introduced Cumulative Impact Zones for all new or variation applications for 'Off' licences in the borough.

This application falls within a Cumulative Impact Zone.

#### 3. Promotion of the Licensing Objectives

See page 3 of the application

#### 4. Relevant Representations

Representations have been received from the Police and Licensing Officers who request that the application is refused.

#### 5. Interested Parties

None

#### 6. Policy Considerations

##### Policy 1 – Process for Applications

Conditions on the licence, additional to those voluntarily sought/agreed by the applicant, may be considered. Conditions will focus on matters which are within the control of individual licensee and which relate to the premises or areas being used for licensable activities, the potential impact of the resulting activities in the vicinity. If situations arise where the licensing objectives may be undermined but cannot be dealt with by the use of appropriate conditions the Licensing Authority will consider whether it is appropriate for a licence to be granted or continue to operate.

## **7. Determination of the Application**

Members can take the following steps when determining a new premises licence application:

- grant the licence;
- exclude from the scope of the licence any of the licensable activities to which the application relates;
- refuse to specify a person in the licence as the premises supervisor;
- reject the application

## **8. Associated Papers**

- A. Application Form & Plan
- B. Police Representation
- C. Licensing Representation
- D. OS Map

**LICENSING ACT 2003**

**Licence: Premises Licence New Application**

**Application No: 28920**

Dear Sir/Madam,

**Applicant: Mr KAJANTHAN KARTHIGESU**

**Date Received: 18 July 2023**

An application was made to Brent Council under the Licensing Act 2003 by the above-named applicant. Representations must specify in detail the grounds of opposition and must relate to the promotion of the licensing objectives.

In order that consideration of the application may not be delayed, it will be appreciated if a reply can be sent to us by **15 August 2023**.

Yours faithfully

[Redacted]  
[Redacted]  
Regulatory Services

**Part 1 – Premises Details**

Postal address of premises, or if none, ordinance survey map reference or description

**Newsfare**

**33 Craven Park Road, London, Brent, NW10 8SE**

Telephone Number at premises (if any):

Non domestic rateable value:

**Part 2 – Applicant Details**

Proposed Licence Holder:

Mr KAJANTHAN KARTHIGESU

[Redacted]  
[Redacted]  
[Redacted]



**Part 3 – Operating Schedule**

When do you want the premises licence to start? 12-08-2023

If you wish the licence to be valid only for a limited period, when do you want it to end?

If 5,000 or more people are expected to attend the premises at any one time, please state the number expected to attend:

Please give a general description of the premises: New Premises Licence for Retail sale of Intoxicating Liquor of all descriptions for consumption off the premises and the opening hours for the sale by retail of alcohol are as follows: - Monday to Sunday: 07.00 – 23.00

**What licensable activities do you intend to carry on from the premises?**

Section J: Sale of alcohol: Off the premises

The times the licence authorises the carrying out of licensable activities

<b>Section J: Sale or Supply of Alcohol: Off the premises</b>		
<b>Day</b>	<b>Start Time</b>	<b>End Time</b>
Monday	07:00	23:00
Tuesday	07:00	23:00
Wednesday	07:00	23:00
Thursday	07:00	23:00
Friday	07:00	23:00
Saturday	07:00	23:00
Sunday	07:00	23:00

**State the name and details of the individual whom you wish to specify on the licence as designated premises supervisor:**

Mr. Kajanthan Karthigesu

Date of birth:



Licence Number:



Issuing authority:



**Concerns in respect of Children: n/a**

The opening hours of the premises

<b>Day</b>	<b>Start Time</b>	<b>End Time</b>
Monday	07:00	23:00
Tuesday	07:00	23:00
Wednesday	07:00	23:00
Thursday	07:00	23:00
Friday	07:00	23:00
Saturday	07:00	23:00
Sunday	07:00	23:00



**a) General – all four licensing objectives (b, c, d, e):** will take all measures to ensure all four licensing objectives are followed.

**b) The prevention of crime and disorder:** Full Equipment with CCTV Cameras. Acceptance of accredited proof of age cards. Effective and Responsible management of premises. Training Staffs for prevention of crime and disorder. No violent behaviour. All alcohols sold are to be placed in a carrier bags.

**c) Public safety:** Notices warning customers to potential crime risk and not to leave bag unattended. Signs will be placed on the premises stating restrictions on sale of liquor under 18. Challenge 25 Policy to be maintained. Inform the use of CCTV Cameras. The Fire Extinguisher to be maintained.

**d) The prevention of public nuisance:** Discourage and report to police any groups of youths hanging outside the premises. Last admission is between 22.50 to 22.55 (Monday to Sunday). Two members of staff to be on the premises after 6.00pm until close. There will be no disturbances by staff leaving the premises after closing hours.

**e) The protection of children from harm:** Especially request of age of proof cards for children. Training staff to prevent children from any kinds of drugs or drinking. Trained staff for prevention of any kind s of incidents of violence and disorder affecting children. Refusal register to be on the premises at all times.

This page is intentionally left blank

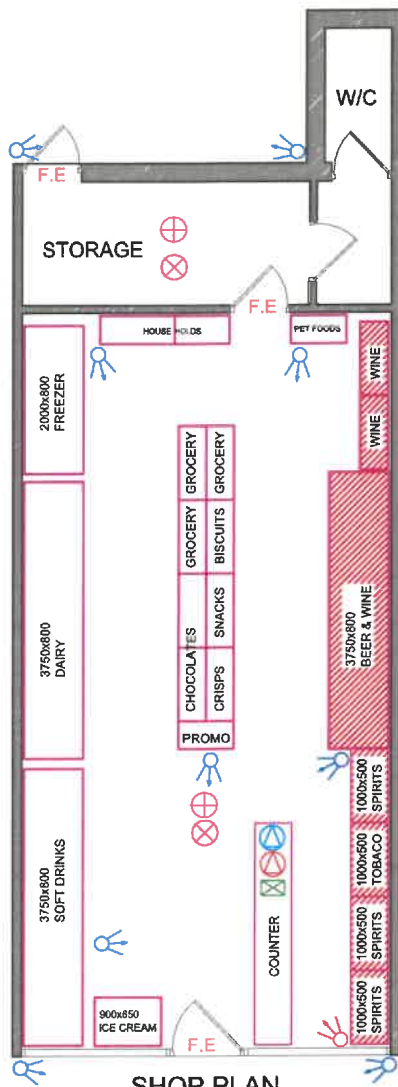

- KEYS:**
- F.E - Fire Exit
  - ⊕ - Fire Alarm
  - ⊗ - Smoke Detector
  - ⊕ (with blue circle) - Fire Extinguisher (Foam)
  - ⊕ (with red circle) - Fire Extinguisher(H2O)
  - 👤 - CCTV
  - ⊗ (with green cross) - First Aid equipment

**SHOP PLAN**  
Scale 1:100

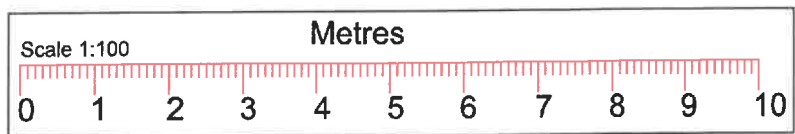

TITLE : SHOP PLAN.



Contact: M.Mathu(BSc, MSc Civil Engineering)  
Tel : 07515365953 Web:mkmdesigns.co.uk  
Email: mathu\_eng@yahoo.co.uk

Notes : # This Drawing is Copyright of MKM ARCHI DESIGN LTD.  
# Contractor/Builder to check all dimension on site, Before commencement of any works. Figured dimension only to be used.  
# All work shall comply with the latest Building Regulations & be to the satisfaction of the L. Authority.  
# Materials shall be suitable for the purpose for which they are used & the quality shall not be lower than that defined in the relevant British standard.

NAME :  
ADDRESS : 33 CRAVEN PARK ROAD,  
HARLESDEN,  
NW10 8SE.

Drg No : ARC/23/GRA33/SP02 Scale : Shown@A4 Drwn By: M.Mathu Date : 13/07/2023 Page : 01/01

This page is intentionally left blank



**METROPOLITAN  
POLICE**

Working together for a safer London

TERRITORIAL POLICING

***Brent Police Licensing Unit***

*Brent Civic Centre  
Engineers Way  
Wembley  
Middlesex  
HA9 0FJ*

***NW BCU Licensing Department - Brent***

*Harrow Police Station  
74, Northolt Road  
Harrow  
HA2 0DN*

***Tel: 020 8733 5008***

***Email:***

*nwmailbox.licensingbrent@met.police.uk*

***Web:*** *www.met.police.uk*

***Your Ref:*** 28920

***Our ref:*** 01QK/531/23/1187NW

***Date:*** 09<sup>th</sup> August 2023

**Police representations to the application for a new Premises Licence for 'Newsfare, 33, Craven Park Road, NW10 8SE'**

**Police certify that we have considered the application shown above and wish to make representations that the likely effect of the grant of the application is detrimental to the Council's Licensing Objectives for the reasons indicated below.**

**Officer: PC Brendon MCINNES  
Licensing Constable 1187NW**

An officer of the Metropolitan Police, in whose area the premises are situated, who is authorised for the purposes of exercising its statutory function as a 'Responsible Authority' under the Licensing Act 2003.

The application has been made for a new premises licence under section 17 of the Licensing act 2003. The Police representations are concerned with all four of the licensing objectives, namely:

- The prevention of crime and disorder;
- Public safety;
- The prevention of public nuisance; and
- The protection of children from harm.

**The Application**

The application is for a new Off License / Convenience Store in Craven Park Road in between Manor Park Road Tavistock Road.

The applicant is asking for venue to be open from 07.00 hours to 23.00 hours Monday through to Sunday. The sale of alcohol is requested from 07.00 hours to 22.00 hours Monday through to Sunday.

The application quite rightly states that the venue is located within one of Brent's Cumulative Impact Zones (CIZ).

### **Cumulative Impact Zones**

Brent Council Licensing Policy introduced CIZ's on 7<sup>th</sup> January 2020 in order to combat a rise in crime, disorder, public nuisance, anti-social behaviour and street drinking all of which is fuelled by the sale and consumption of alcohol

There are many studies reflecting the relationship between alcohol consumption/abuse with increases in ASB and violent crimes, as highlighted by such organisations as the Institute of Alcohol Studies. There is also evidence that the most disadvantaged of socio-economic groups (as represented by some of the local populous) that they are disproportionately at risk of alcohol-related violence.

### **Police Representations**

I've run intelligence checks on Craven Park Road where the venue is situated from 08/02/2023 to 08/08/2023 (a six month period), which shows the following figures:-

- (a) One Hundred and fifty four (154) Recorded crimes. These are a wide variety of crimes including assaults, possession of drugs, racially aggravated public order offences, GBH, domestic assaults and numerous thefts.
- (b) Two Hundred and forty (240) Calls to police.
- (c) Thirty seven (37) Stop and searches by police.
- (d) Forty six (46) Arrests.
- (e) Thirty (30) calls for Anti-social behaviour.

Overall there are 507 intelligence hits for this stretch of road. None of these figures include the surrounding roads such as, Manor Park Road, High Street Harlesden, Park Parade, Acton Lane and Station Road. All which is a two minute walk from where the venue is situated.

In addition to this area which is already suffering from very high crime figures, there are at present Seven (7) other licensed premises selling alcohol to the public in Craven Park Road, never mind the surrounding roads mentioned above. This community does not require another venue selling alcohol which will only fuel the street crime, ASB and create price wars between rival off licenses.

The applicant is for a 'standard' off license / convenience store with no 'speciality' theme or products. I see no benefits in adding another bog standard off license to Neasden Lane with the existing crime rate.

Taking into account of Police concerns and guidance related to CIZ's given in the Brent Council guidance; the presumption is that the application will be refused unless the applicant can satisfactorily evidence that their application or variation will not negatively impact on the licensing objectives.

Due to all the points raised above, the Police licensing team oppose the granting of this premises licence.

Yours Sincerely,

**PC Brendon MCINNES**  
**NW BCU - Brent Licensing**  
**Brendon.McInness@met.police.uk**

This page is intentionally left blank



---

Kajanthan Karthigesu  
Newsfare  
33 Craven Park Road  
NW10 8SE

14 August 2023

Our Ref: 28920

Dear Kajanthan Karthigesu,

**Licensing Representation to the Initial Application for the Premises Licence at Newsfare, 33 Craven Park Road, London, NW10 8SE**

I certify that I have considered the application shown above and I wish to make a representation that the likely effect of the grant of the application is detrimental to the Licensing Objectives for the reasons indicated below.

**An officer of the Licensing Authority, in whose area the premises are situated, who is authorised for the purposes of exercising its statutory function as a 'Responsible Authority' under the Licensing Act 2003.**

**The application has been made for a new premises licence under section 17 of the Act.**

The Licensing Authority representations are primarily concerned with the four licensing objectives;

- the prevention of crime and disorder;
- public safety;
- the prevention of public nuisance; and
- the protection of children from harm.

**Cumulative Impact Zone (CIZ)**

The Council's current Licensing Policy came into effect 7th January 2020. Crime and complaints assessments in 2015, did not identify any requirement for a CIZs. However, since 2016 there has been a significant and notable increase in alcohol related crime and anti-social behaviour which is having an adverse impact in some areas and neighbourhoods generating complaints from residents, councillors and the Police. This is undermining the licensing objectives and also has potential to undermine the vitality of Brent's town centres.

Data captured from various sources including alcohol related police and ambulance call outs have been mapped and have shown suitable evidence to implement CIZs in the specified areas. In

particular crime data and evidence shows a correlation between concentrations of off-licences and alcohol related anti-social behaviour, particularly that associated with street drinking.

Harlesden has been identified as one of ten Cumulative Impact Zones (CIZs) in Brent, where the authorising of further licences may undermine the promotion of the licensing objectives.

The Statement of Licensing Policy states: -

### **Harlesden**

Harlesden Town Centre is a hotspot for alcohol flagged calls to the Police for crime and anti-social behaviour. It is also a hotspot for ambulance calls where the victim has sustained an injury. The data shows the whole of the town centre suffers from high levels of alcohol related issues, including residential streets off the main town centre such as Rucklidge Avenue, Wendover Road, Buckingham Road and St Albans Road.

Data captured from various sources including alcohol related police and ambulance call outs have been mapped and have shown suitable evidence to implement CIZs in the specified areas. In particular crime data and evidence shows a correlation between concentrations of off-licences and alcohol related anti-social behaviour, particularly that associated with street drinking. Therefore, it is proposed that a CIZ be introduced for off-licences for the following streets; Craven Park, Craven Park Road, Park Parade and High Street Harlesden

### **Street Drinking Hotspots**

There are relatively few calls to police specifically about street drinking. This may be because they are recorded as other ASB types such as littering or noise. Between 01/06/2017 and 31/05/2018, there were only 53 calls to police. The following year, there were 142. This represents an increase of 168%. Part of this increase may be attributed to callers being aware of the borough wide PSPO on drinking in public which came into effect in October 2017.



*Calls to police specifically related to street drinking between 01/06/2017 and 31/05/2019*

**Hotspots in Brent in Ambulance and Police alcohol flagged call out data**



*Alcohol-related ambulance and Police calls between 01/06/2017 to 31/05/2019*

**Hotspot of Violence with Injury Crimes**

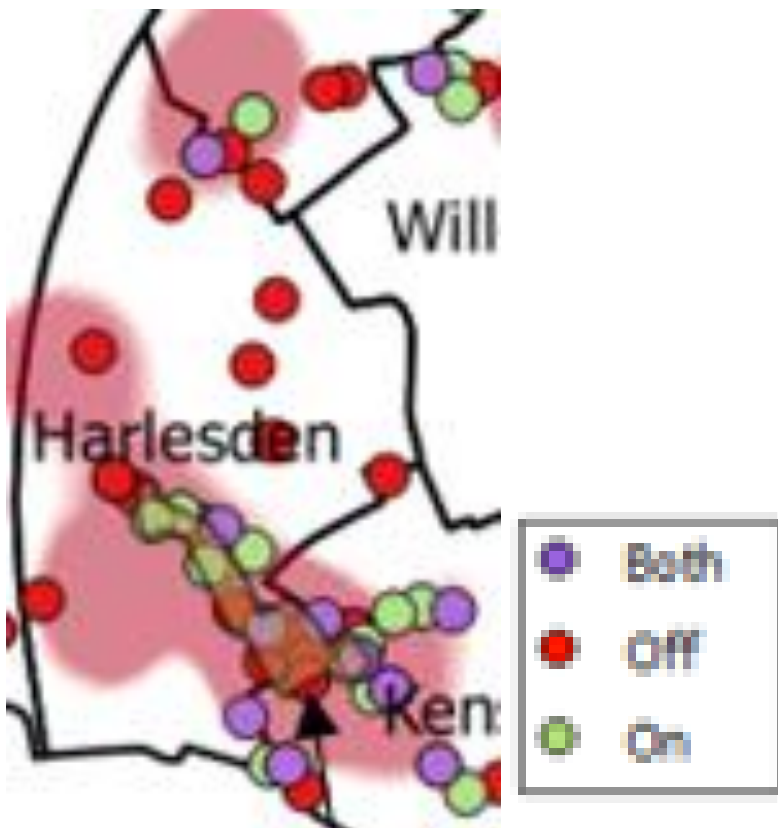

*All violence with injury crimes between 01/06/2017 and 31/05/2019*

## **Brent Index of Multiple Deprivation (IMD) score 2015 by Lower Super Output Areas**

The Index of Multiple is made up of income deprivation, employment deprivation, education, skills and training deprivation, health deprivation and disability, crime, barriers to housing services and living environment.

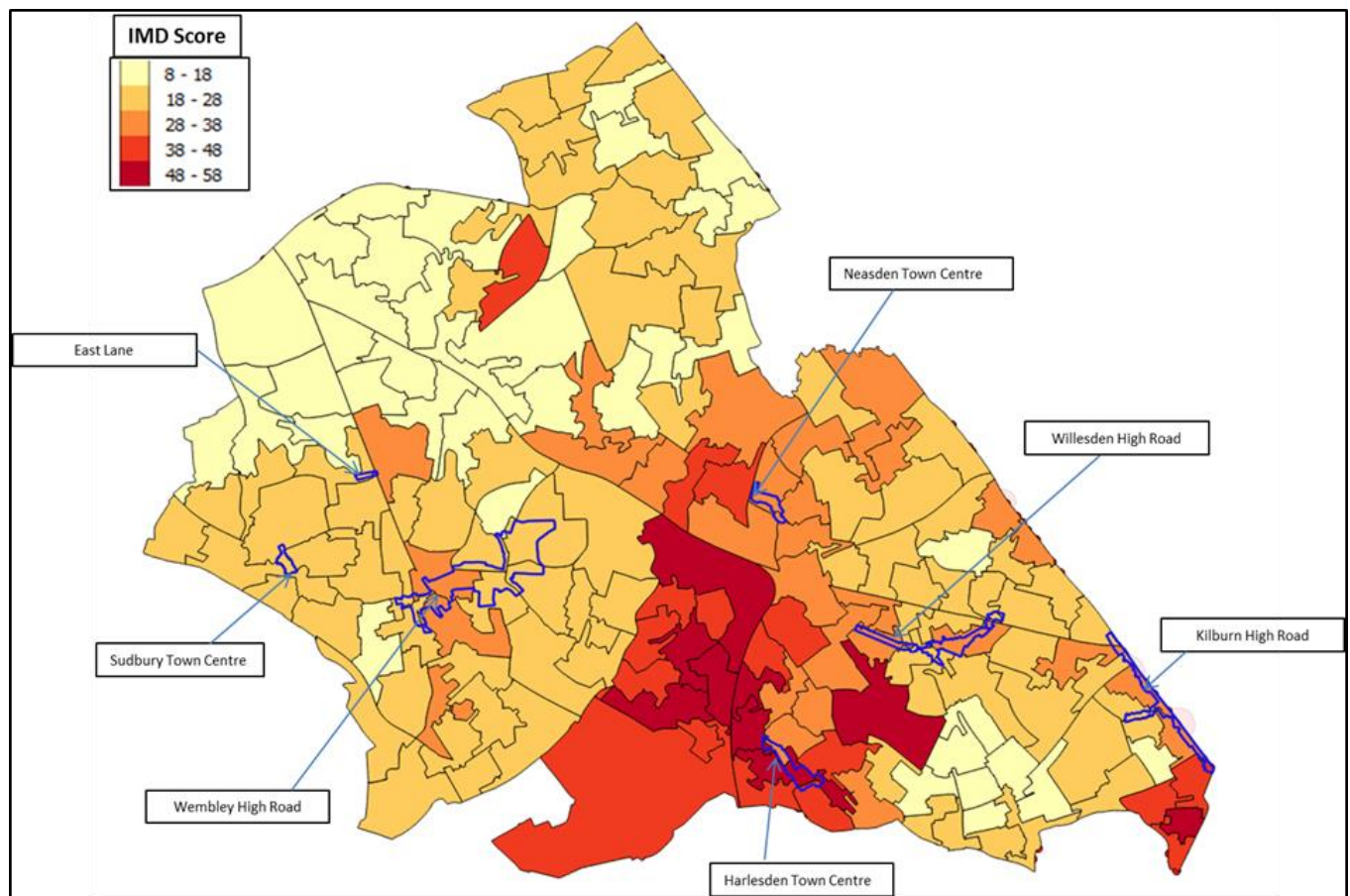

*Brent Index of Multiple Deprivation (IMD) score 2015 by Lower Super Output Areas*

The purpose of the CIZ in Harlesden (Craven Park Road) is to address the issues mentioned above.

### **The Premises**

The premises, namely Newsfare, 33 Craven Park Road, London, NW10 8SE falls within one of Brent's ten CIZs.



Newsfare, 33 Craven Park Road, London, NW10 8SE

Harlesden town centre consists of a series of parades of shops that run along Craven Park, Craven Park Road, Park Parade and High Street Harlesden. The town centre falls between, Harlesden and Kensal Green ward and is one of the most deprived areas in the borough. There are a number of existing off licences within a 4 minute walk.

Current Off Licences near Proposed Premises	Walking Distance from Proposed Premises
Who's Next, 6 Library Parade	1 minute (240ft)
Komoto Mini Mart 126 Craven Park Road	4 minutes (0.2mile)
Craven Park Off Licence, 102 Craven Park	4 minutes (0.2mile)
Corner Road Shop, 98 Craven Park Road	3 minutes (0.2mile)
Supersave, 68 Craven Park Road	2 minutes (486 ft)
PS Drinks, 43 Craven Park Road	1 minute (95ft)
Tamariz Deli, 24 Craven Park Road	2 minutes (400ft)
Housewives Cash & Carry, 14 Craven Park Road	2 minutes (0.1mile)
Shady's, 164 Manor Park Road	1 minute (246ft)
Beers, Wines & Spirits, 21 High Street	2 minutes (0.1mile)
Poziomka, 30-32 High Street	2 minutes (0.1mile)
Way 2 Save, 37-41 High Street	2 minutes (0.1mile)

### **Public Space Protection Order (PSPO)**

The entire Borough of Brent is subject to a Public Space Protection Order for street drinking and therefore it is an offence to drink alcohol in any public place.

If a police officer reasonably believes that a person is, or has been, consuming intoxicating liquor within these areas, the officer may require the person concerned:



- a) not to consume in that place anything which is, or which the officer reasonably believes to be, intoxicating liquor
- b) to surrender anything in his/her possession which is, or which the officer reasonably believes to be, intoxicating liquor or a container for such liquor (other than a sealed container)
- c) An officer may dispose of anything surrendered to him/her as above.
- d) Issue fixed penalty notices on offenders
- e) Prosecute persistent offenders

However, in reality there are limited police officer resources, which in practice would prevent the above from being enforced. This therefore places a greater emphasis on the responsibility of those premises that are selling alcohol for consumption off the premises. It is clear that if off licences did not exist, the number of street drinkers would decline.

Therefore simply selling alcohol to customers who once off the premises, are no longer the responsibility of the licence holder, the Designated Premises Supervisor (DPS) and/or members of staff is no longer a viable option.

### **Premises Licence Application**

#### **Operational Plan, Training Manual & Conditions.**

The Licensing Authority would expect to see information on how the business plans to ensure that their particular premises will go above and beyond in promoting the licensing objectives in a crime hot spot. In this case, the applicant has provided vague details on they will uphold the licensing objectives.

#### **Safeguarding the Local Area**

The Statement of Licensing Policy lists considerations to be made when applying for a new premises licence, particularly those considerations relating to street drinking.

However, there are no specific conditions that are mentioned in the application to address the likes of such things outside of the premises that could be directly linked back to the premises. This includes items such as the clearing up of litter which may be left outside the premises by customers, the labelling of alcohol with the premises name in order to link street drinkers back to the premises or measures to discourage street drinkers from loitering outside the premises.

As per Brent Council's Statement of Licensing Policy, a voluntary offering of a ban on high strength alcohol sales does not necessarily address the requirements under a Cumulative Impact Zone.

#### **The Plan**

The plan appended to the application for a new premises licence indicate a traditional off licence layout.

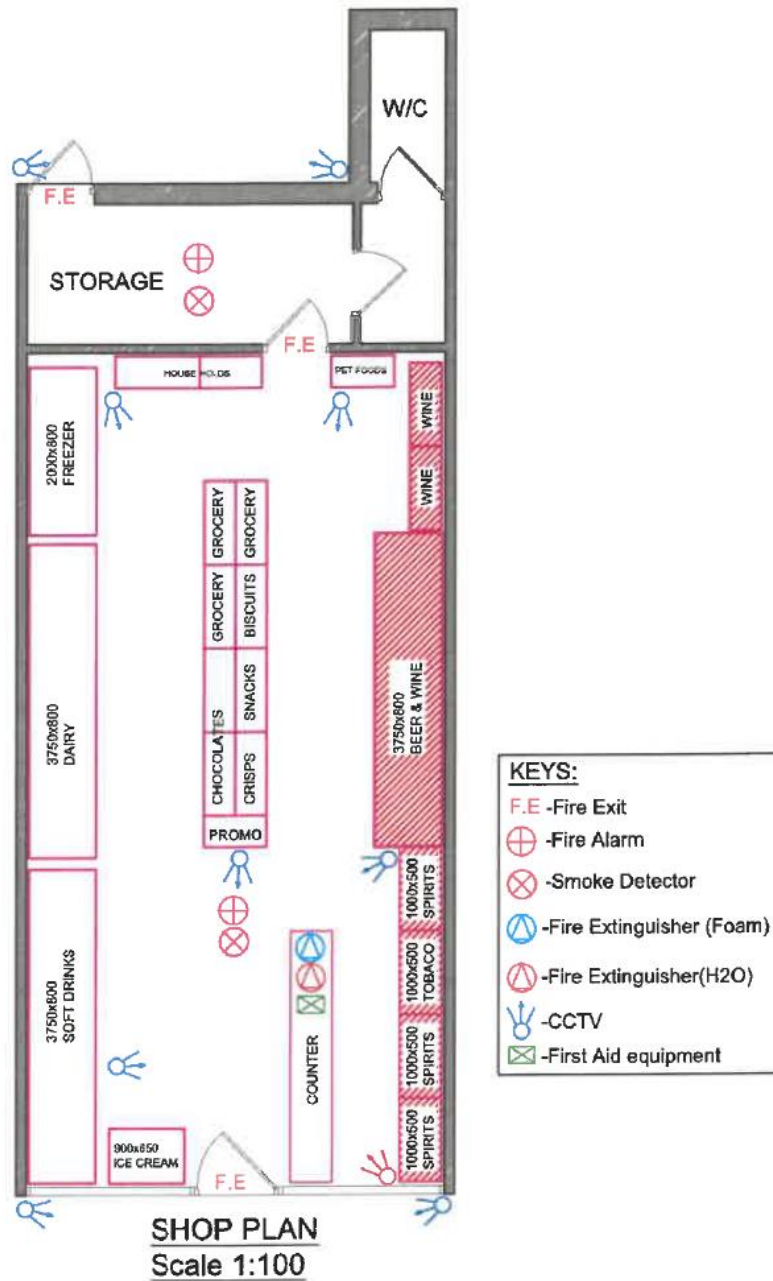

On the 11 August 2023, I spoke with the applicant and proposed DPS Kajanthan Karthigesu via telephone to obtain further information related to the application.

The following questions were asked and recorded below:

Esther Chan (LA): When did you take over the premises?

**Kajanthan Karthi: The paperwork is still with the solicitor, about 70 % of the way to completion.**

Esther Chan (LA): When do you intend to take over the premises?

**Kajanthan Karthi: I am waiting for the premise licence to go through before taking over.**

Esther Chan (LA): Who pays the Business Rates?

**Kajanthan Karthigesu: The landlord is responsible for the business rate. I will pay when I take over.**

Esther Chan (LA): Did you complete the application yourself?

**Kajanthan Karthigesu: My solicitor filled the application.**

Esther Chan (LA): Did you read the application and happy with the content?

**Kajanthan Karthigesu: Yes I read it.**

Esther Chan(LA): Are you aware that the premises fall in a CIZ and do you know what that means?

**Kajanthan Karthigesu: The solicitor told me but I don't really understand.**

Esther Chan (LA): Are you aware of the issues in the area?

**Kajanthan Karthigesu: I know the area. My brother had a premises in Neasden and I use to work for him in an off licence. People are alright. There is always something happening in the area and I'm not too bothered about the issues.**

Esther Chan (LA): Can you explain any specific ASB issues near the premises?

**Kajanthan Karthigesu: Everywhere has a problem, not just Harlesden. There are issues with young boys, not alcohol problems.**

Esther Chan (LA): There are many existing off licences in local area, why do you want to open another off licence?

**Kajanthan Karthigesu: Why not, we need the business to pay VAT, taxes. We need to do the business.**

Esther Chan (LA): Do you intend to sell high strength beers, ciders and lagers over 6% abv?

**Kajanthan Karthigesu: I don't really need it.**

Esther Chan (LA): When did you undertake a personal licence course?

**Kajanthan Karthigesu: A long time ago, over eight years ago.**

Esther Chan (LA): Explain the 4 licensing objectives?

**Kajanthan Karthigesu, Challenge 25 is the main thing, need to check photo ID. Too many wrong people, you don't want to sell it.**

Esther Chan (LA): Can you explain the age verification policy that you intend to adopt?

**Kajanthan Karthigesu: Challenge 18.**

Esther Chan (LA): How staff will you employ?

**Kajanthan Karthigesu: After 3pm, I will keep 2 staff always.**

Esther Chan (LA): What will be responsible for the training?

**Kajanthan Karthigesu: me**

Esther Chan (LA): If the application is refused, will you keep the lease and continue to trade?

**Kajanthan Karthigesu: I will keep the lease.**

Esther Chan (LA) – Do you experience running an off licence?



**Kajanthan Karthigesu – I already have an Off Licence in Hammersmith Council. I am DPS at that the premises. Once I took over this premises, I will locate in the new shop mainly.**

Esther Chan (LA) – What sort goods and services will you provide at the premises?

**Kajanthan Karthigesu: Grocery items, confectionary goods, soft drinks, wines and beers. Lottery and oyster card. I will apply for Paypoint.**

Based on my conversation with Kajanthan Karthigesu, I am not confident that he will be able to uphold the licensing objectives.

He appears to have limited understanding with regards to the CIZ and could not provide definitive answers to the four licensing objectives and the age verification policy.

There is nothing to suggest that the premise will offering any niche products other than typical goods you would expect to find at an local off licence baring in mind, there are many existing grocery and off licence premises located in the area.

Kajanthan Karthigesu initially stated that he would require the premise licence to determine whether he takes over the business but later confirmed he will keep the lease if the application for a new premise licence is refused.

Harlesden is a challenging area of the Borough fuelled with anti social behaviour including street drinking, therefore adding another off licence in the area will not benefit the wider community in my opinion.

## **Summary**

The Statement of Licensing Policy states that any licence application in a CIZ area will need to demonstrate with evidence that its operation will not add to any cumulative impacts that the CIZ is seeking to address. Further, new applicants and those applying for variations would be required to demonstrate how their premises will not contribute to street drinking in those areas.

The effect of adopting a CIZ is to “create a rebuttable presumption” that applications for licences which are likely to add to the existing cumulative impact will normally be refused (or subject to certain limitations) unless the applicant can demonstrate that there will be no negative cumulative impact on the licensing objectives.

The operating schedule fails to demonstrate that a grant will not lead to a negative cumulative impact on one or more of the licensing objectives and to the contrary add to the issues of an existing saturated area.

It is on this basis, that the Licensing Authority ask that the application for a new premises licence is **refused** by the Licensing Sub-Committee. Adding conditions to a premises licence, in the Licensing Authority’s opinion is not adequate when the application does not demonstrate what is being put in place in order to avoid further cumulative impact. Adding an additional off licence to the eight that already exist in the immediate area, will no doubt be detrimental to the local area.

If the committee however decide that there is sufficient evidence to the contrary, the Licensing Authority would ask that the following conditions be added to the operating schedule:-

The Licensing Authority require the following points to be included in the operating schedule or added as conditions on the premises licence:

1. CCTV shall be installed to Home Office Guidance standards and maintained in a good working condition and recordings shall be kept for 31 days and shall be made available to police and authorised Officers from Brent Council.
2. The CCTV system shall be capable of obtaining clear facial recognition images and a clear head and shoulders image of every person entering or leaving the premises.
3. A CCTV camera shall be installed to cover the entrance to the premises and further cameras to cover the entire servery area and till.
4. A member of staff shall always be present on the premises whilst they are open who is capable operating the CCTV system and able to facilitate immediate viewing of CCTV footage upon the request of the Police and Authorised Officer of the Licensing Authority.
5. A "Challenge 25" policy shall be adopted and adhered to at all times.
6. A sign stating "No proof of age – No sale" shall be displayed at the point of sale.
7. A copy of the premises licence summary including the hours which licensable activities are permitted shall be visible from the outside of each entrance to the premises.
8. Any staff directly involved in selling alcohol for retail to consumers, staff who provide training and all managers will undergo regular training (every 12 months) of Licensing Act 2003 legislation. This will be documented and signed for by the DPS and the member of staff receiving the training. This training log shall be kept on the premises and made available for inspection by police and relevant authorities upon request.
9. Outside of the hours authorised for the sale of alcohol, all alcohol within the trading area is to be secured behind locked grills, locked screens or locked cabinet doors so as to prevent access to the alcohol by customers or staff.
10. All alcoholic drinks shall be clearly labelled or marked with the name of the premises.
11. A notice asking Customers to leave quietly from the premises shall be displayed by the exit/entrance.
12. A single incident log shall be kept at the premises, and made available for inspection on request to an authorised officer of Brent Council or the Police, which will record the following:
  - (a) all crimes reported to the venue
  - (b) all ejections of patrons
  - (c) any complaints received
  - (d) any incidents of disorder
  - (e) all seizures of drugs or offensive weapons
  - (f) any faults in the CCTV system
  - (g) any refusal of the sale of alcohol
  - (h) any visit by a relevant authority or emergency service.

13. No high strength beers, lagers, and ciders above 6% ABV shall be stocked or sold at the premises.

14. No single cans of beer, larger or cider be sold.

15. No miniatures (5cl or 50ml) to be sold.

16. A clear and unobstructed view into the premises shall be maintained at all times.

17. Invoices are to be produced to Police, a member of an appropriate authority or council officers upon request to evidence payment of duty on goods.

18. All deliveries shall take place during the normal working day (i.e. 09:00 to 18:00 daily).

19. A lockable safe with deposit slot and anti-fishing mechanisms must be used at the counter till area in order to prevent crime.

20. A suitable intruder alarm and panic button shall be fitted and maintained.

21. A personal licence holder shall be present on the premises and supervise the sale of alcohol throughout the permitted hours for the sale of alcohol.

22. All alcoholic drinks shall be clearly labelled or marked with the name of the premises.

24. An electronic till prompt should be used for all alcohol sales.

25. The premises shall be staffed by a minimum of two persons after 15:00hours.

**Supply of Alcohol (Changed)**

Monday to Sunday – 10:00hrs to 23:00hrs

**Opening Hours (No Change)**

Monday to Sunday – 07:00hrs to 23:00hrs

Yours faithfully



Esther Chan  
Licensing Inspector  
Regulatory Services

This page is intentionally left blank

Basemap Map

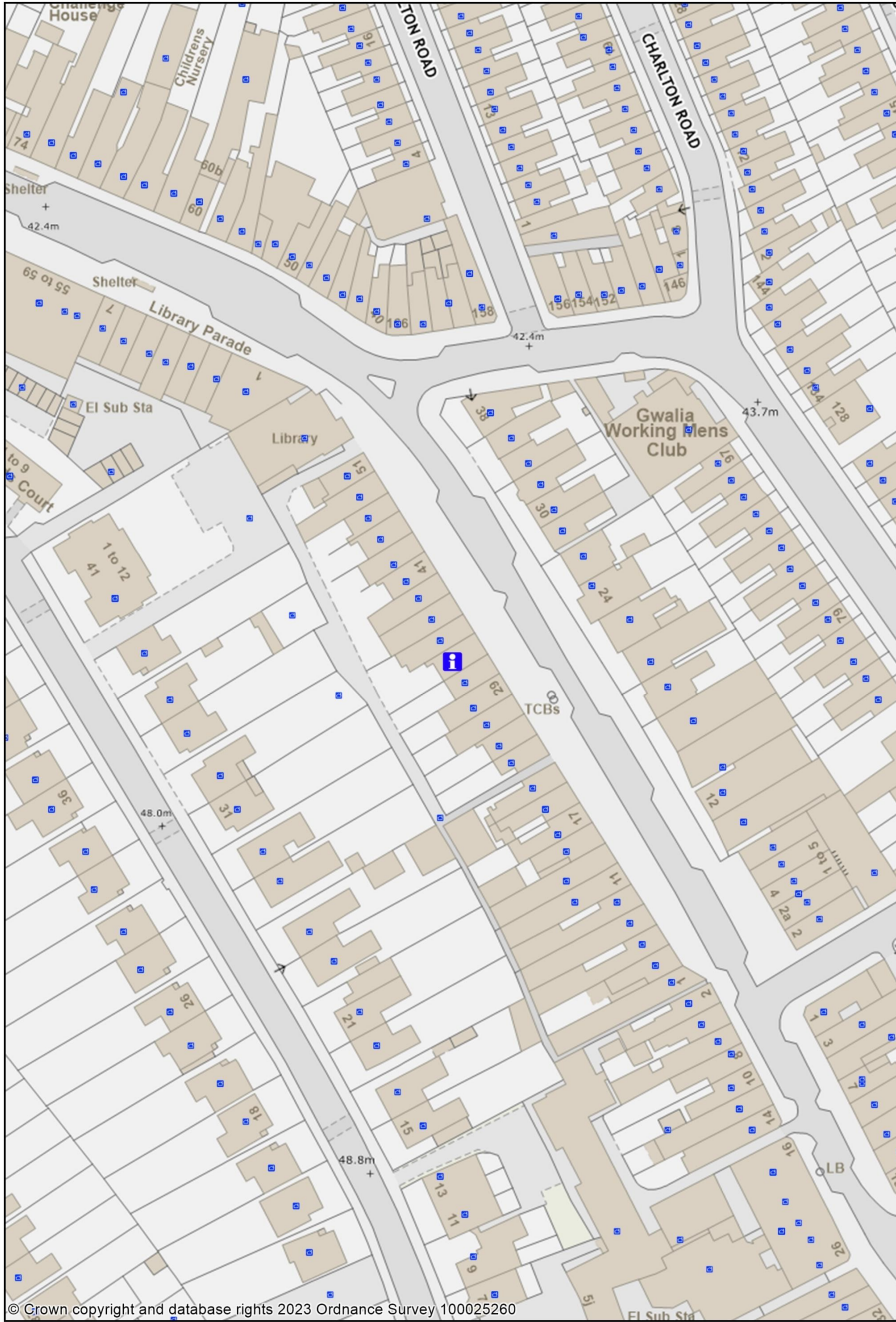

1:1250

0 0.02 0.04 kilometres



This page is intentionally left blank

## Newsfare – 33 Craven Park Road NW10 8SE – Further supporting evidence

Below is a map from the Metropolitan police web page (available to the public) highlighting the crime figures for the NW10 8SE post code. As you can see from this map the majority of the crime figures are in Craven Park Road where this application is.

All Crimes (300)

July 2023



The next image (from the same site) shows the breakdown of the crime types. Anti-social behaviour been the highest, followed by violent and sexual offences and finally drug related crime. This figures and maps speak for themselves. The connection between alcohol and crime is well documented and adding another off license to this area already suffering from these crime figures is the last thing the community of Willesden / Brent need.



The final image is that of the ward priorities. This details how the local policing team along with the local authority have street drinking, violent crime, ASB and drugs and their main complaint from residents and councillors. Brent Council’s CIZ policy, detailed below details their concerns over these exact issues, which is why this area of Brent does not require another off license which will just create a price war between rival shops, lowering the cost and increasing the crime and ASB



## Our priorities



### Priority:

Violence Related Priority

To reduce violence and drug dealing in the area of Harlesden High Street - Harrow Road NW10 and in the area of Park Parade, Leghorn Road, Harlesden Gardens NW10 .

Issued 10 September 2023

### Action taken:

No update available

### Priority:

ASB and Street Drinking in Station Road NW10

To work closely with Brent Council, Businesses and resident of Station Road in order to reduce drugs and Street Drinking problem in Station Road and Surrounding area.

Issued 10 September 2023

This page is intentionally left blank